

User Manual

Puffpaw Smart Vape

Table of Contents

Puffpaw Smart Vape (PSV)	1
PACKAGE CONTENTS	1
DISCLAIMER	2
COMPONENTS VIEW	3
RECOMMENDED SETUP	4
HANDLING AND USAGE SAFETY	5
COIL MAINTENANCE SAFETY	6
BATTERY SAFETY	6
DEVICE OVERVIEW AND SETUP	7
DISPLAY INTERFACES	7
BASIC CONTROLS	9

OPERATING INSTRUCTIONS	11
POD SYSTEM OPERATION	11
BLUETOOTH CONNECTIVITY	14
NFC SOCIAL FEATURES	15
RESETTING YOUR DEVICE	17
 CHARGING AND BATTERY	18
MANAGEMENT	
CHARGING INSTRUCTIONS	18
SMART CHARGING FEATURES	19
BATTERY PROTECTION	19
PUFF DURATION SAFETY LIMIT	20
 MAINTENANCE AND CARE	22
REGULAR MAINTENANCE	22
DEVICE INFORMATION	22

IMPORTANT INFORMATION ABOUT ... 23

USING NICOTINE-CONTAINING E-LIQUIDS

NICOTINE-CONTAINING **23**
E-LIQUID

NICOTINE WARNINGS AND **24**
PRECAUTIONS

POSSIBLE SIDE EFFECTS **26**

WARRANTY 27

IMPORTANT INFORMATION **27**

TECHNICAL SPECIFICATIONS 29

Puffpaw Smart Vape (PSV)

Welcome to the Puffpaw family! Our mission is to guide you toward a healthier lifestyle through innovative technology and gamified experiences. This manual will help you get the most out of your first-generation Puffpaw Smart Vape.

PACKAGE CONTENTS



PSV



Tyce-C Cable



User Manual



Puff pod Twilight
Oolong Essence



Puff pod
Electric Blue Razz



Puff pod
Strawbreeze

DISCLAIMER

Please read this user manual before use. Failure to follow the instructions for proper setup, use, and care for your device can increase the risk of serious personal injury, death, or property damage. The manufacturer assumes no responsibility for any damage caused by mishandling that is beyond normal usage defined in this manual.

COMPONENTS VIEW

Reset button(D)

Press to restore software malfunction, may require a pin to reach

Pod Slot

Securely holds the pod with a see-thru feature

Power Button(A)

Press to turn on/off screen

Up Button(B)

Navigate Up

Down Button(C)

Navigate Down

Charging Port(USB-C)

Screen

Displays everything you need to know about the vape

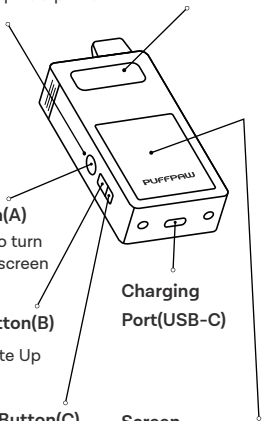

NFC reader

For social
function only

NFC side tag

For social
function only

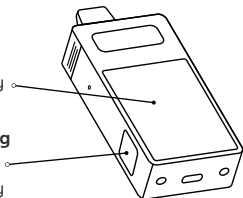

RECOMMENDED SETUP

We recommend the exclusive use of Puffpaw original cable, battery, components, and accessories indicated on the product page and leaflet.

Use of chargers, batteries, components, and/or accessories not specifically produced for this device may lead to malfunction and/or damage to the product and to the cancellation of the warranty.

HANDLING AND USAGE SAFETY

To reduce the risk of fire, shock, or damage to your vape device keep the product and its accessories away from overheated or excessively humid conditions (-5°C/50°C).

Your device can be damaged if dropped, burned, punctured, crushed, or if it comes in contact with liquid. If you suspect damage to your device or its battery, discontinue use of your device, as it may cause overheating or injury.

To avoid misfiring, always ensure you either lock or switch off your device when it is not in use, especially when carrying your device in your pocket, bag, or purse.

In the case of burnt or abnormal deformation of one of the components of the device or its accessories, stop using it

immediately and contact Customer Care.

COIL MAINTENANCE SAFETY

In order not to damage the coil or burn the cotton do not inhale an empty pod. Puffpaw pods feature liquid-coil separation technology. Please push the heating core into the pod, and wait 5 minutes before first use for optimal flavor.

BATTERY SAFETY

Do not try replacing the battery, as this voids the warranty. Do not use Vape while charging cable is plugged in. Disconnect the cable from vape, when vape is fully recharged. Do not pierce, or damage the internal battery in any way.

DEVICE OVERVIEW AND SETUP

DISPLAY INTERFACES

Your Puffpaw Smart Vape features a high-definition display with multiple customization options to enhance your experience:

Main Dashboards

Main Screen A

Check current time and battery status



Main Screen B

Monitor your rewards (\$0.0/0.00%), also tracks the usage of the pod with a simple progress bar

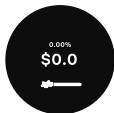

Main Screen C

Only active when you are vaping, tracks your current puff counts(eg. 100 puffs)



Wallpaper Options

- Three pre-installed themes
- Custom wallpaper import via Puffpaw app
- Theme switching using navigation buttons

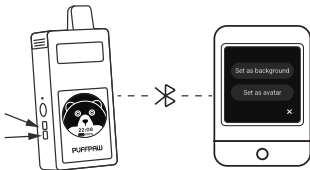

BASIC CONTROLS

Power Button(A):

- Press and hold for 5 seconds: Power on/off
- Single press: Turn the screen on/off



Navigation Buttons (Up & Down, B&C):

- Press: Switch between screens



- Up button(B) special function:
 - Press and hold for 5 seconds: enter software version interface



- Down button(C) special functions:
 - Press and hold for 5 seconds: Turn on NFC reader
 - Three clicks when screen is turned off: Change coin animation



OPERATING INSTRUCTIONS

POD SYSTEM OPERATION

Important Safety Check:

1. Push the heating core into the pod, and wait 5 minutes for optimal flavor.
2. Insert the pod into the vape until seamless, if not, rotate the pod and try again.
 - a. Tips: mouthpiece of the pod should be on the right side of the vape screen.

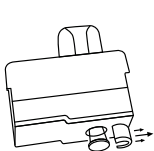

①

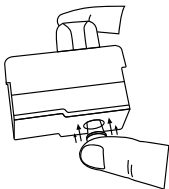

②

3. Check verification logo for genuine pods, the verification logo screen should last 3 seconds upon insertion.

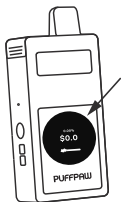

4. You can monitor real-time pod status from main screen.

*Each Puffpaw pod provides approximately 1000 puffs of effective usage. This number is based on results obtained in a controlled lab environment. Actual puff count may vary depending on individual usage habits.

5. Reinsert The Pod Indicator:

When a system update (e.g., Bluetooth upgrade, custom background, or Bluetooth name change) requires a pod reinsert, the screen displays a locked prompt stating "Please Reinsert The Pod". Vaping is disabled until the pod is removed and reinserted. After reinserting,

the screen returns to the default interface. Other functions remain usable during this time.



1

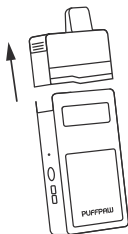

2

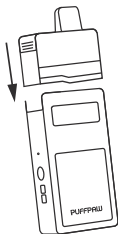

3



4

BLUETOOTH CONNECTIVITY

Connection Management:

- Pair your device using Puffpaw App
- Unpaired device shows "Bluetooth Not Connected"
- Successful pairing shows "Bluetooth Connected"
- Auto-connection check after 5 minutes idle

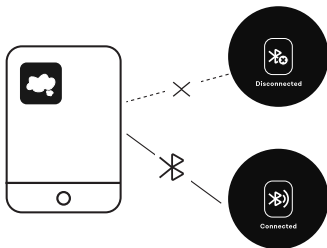

NFC SOCIAL FEATURES

Activation Steps:

1. Press and hold Button C for 5 seconds
2. Watch for NFC reader activation indicator

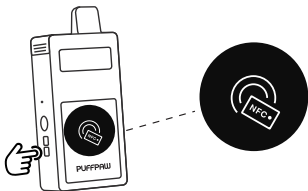

3. Tap your friend's vape NFC side tag to your own vape's back
4. "NFC READ" indicator will show up when successfully read

5. Check Puffpaw App to add your friend

6. NFC reader will deactivate automatically after 3 minutes

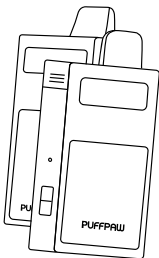
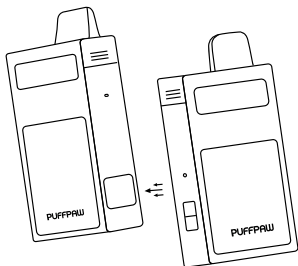

RESETTING YOUR DEVICE

In the event of a software malfunction, such as the vape screen becoming unresponsive, you may resolve the issue by performing the following steps:

1. Locate the small hole above the Power Button (A).
2. Insert a pin or similar tool into the hole.
3. Gently press the Reset Button (D) inside.

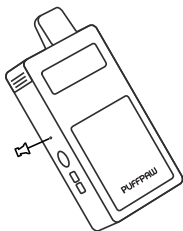

This action will reset the device's software and restore normal functionality.

CHARGING AND BATTERY MANAGEMENT

CHARGING INSTRUCTIONS

- Use included USB-C cable
- Observe charging animation
- Monitor battery indicator for charging status
- Screen dims after 1 minute idle

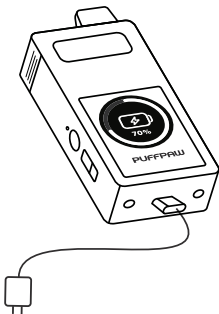

SMART CHARGING FEATURES

- Charging pauses during vaping
- Charging resumes 15 seconds after last puff
- Trickle charge starts at 90% battery
- Final 10% battery charges in 15 minutes

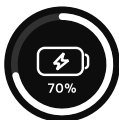

BATTERY PROTECTION

LOW VOLTAGE PROTECTION

Your device features intelligent battery management for optimal performance and safety:

Battery Warning Thresholds:

- Initial warning at 10% battery level (approximately 3.55V)

- Critical warning during use if voltage drops below 3.2V
- Low battery icon displays for 5 seconds before returning to main screen
- Critical warning during use if voltage drops below 3.2V

Note: When low battery warning is active, the battery icon on the main screen will flash to make sure you see it.

PUFF DURATION SAFETY LIMIT

For your safety, the device includes an automatic vaping timeout feature:

- Maximum single puff duration: 7 seconds
- Controlboard automatically stops atomizer output after 7 seconds

- "Cloud Logo" displays as timeout indicator
- Screen returns to main screen after 5 seconds

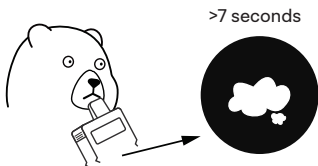

These protective features help ensure safe operation and extend device lifespan.

MAINTENANCE AND CARE

REGULAR MAINTENANCE

- Clean mouthpiece regularly
- Monitor battery health
- Check for firmware updates
- Inspect and make sure pod slot is clean

DEVICE INFORMATION

Access by press and hold Up Button(B) for 5 seconds:

- Current battery voltage
- Software version
- Production date
- Model number
- Bluetooth identifier

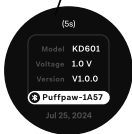

IMPORTANT INFORMATION ABOUT USING NICOTINE-CONTAINING E-LIQUIDS

Before using nicotine-containing e-liquid the user should read the following information carefully.

NICOTINE-CONTAINING E-LIQUID

If used with nicotine-containing liquid, please note that nicotine is a highly addictive substance. Its use is not recommended for non-smokers. Nicotine can produce toxic effects if ingested orally, particularly in infants or children. Do not use nicotine-containing liquids if you are allergic to nicotine or any other ingredients in the e-liquid. Refer to the manufacturer's label for full ingredient details.

NICOTINE WARNINGS AND PRECAUTIONS

1. Addictive Substance

- Nicotine is highly addictive. Use only as intended and avoid prolonged or excessive use.

2. Not Recommended for the Following Individuals:

- Non-smokers
- Children and Infants
- Underage Individuals
- Pregnant or Breastfeeding Individuals
- Individuals Allergic to Nicotine or E-liquid Ingredients
- Individuals with Certain Medical Conditions

3. Toxicity Risks

- Nicotine can be toxic if ingested, particularly by children or pets. Always store nicotine-containing e-liquids securely and out of reach.

4. Safe Handling

- Avoid contact with skin or eyes. In case of accidental exposure, rinse thoroughly with water and seek medical advice if necessary.

5. Storage

- Store e-liquids in a cool, dry place away from direct sunlight, heat, and moisture. Ensure they are kept out of reach of children and pets.

6. Usage Responsibility

- Follow all usage instructions provided by the manufacturer. Misuse of nicotine-containing products can lead to serious health risks.

POSSIBLE SIDE EFFECTS

If you inhale too much nicotine or use the product too much, you may experience one or more of the following effects:

- Feeling faint
- Nausea (feeling sick)
- Headache
- Coughing
- Irritation of the mouth or throat
- Dizziness
- Stomach discomfort
- Hiccups
- Nasal congestion
- Vomiting
- Arrhythmias in the chest
- Abnormal heartbeats

WARRANTY

Please visit our official website below to know our warranty policy and find an official after-sale support center in your country:

<https://www.puffpaw.xyz/support/service-center/>

If your region doesn't have a support center, you can contact the retailer for service as normal.

IMPORTANT INFORMATION

When requesting warranty claims, kindly provide receipts or invoice purchased from vendor. Please also keep the original box containing the serial number and security code, or batch code for verification.

For the latest information, please visit:

User Manual:

<https://puffpaw.xyz/app/manual>

Instruction Videos:

https://www.youtube.com/@puffpaw_xyz

Puffpaw App User Guide:

<https://puffpaw.xyz/app/guide>

TECHNICAL SPECIFICATIONS

1. Hardware Configuration

Configuration	Technical Specifications
MCU	ARM Cortex-M4F 64MHz
SRAM	64KB
Internal FLASH	8Mb
External FLASH	64Mb
Encryption Level	AES128 encryption type
Display Screen	1.54 inch, 240×240 resolution
Power Supply	Rechargeable lithium battery, 3.7~4.2V
Charging Requirements	5~20V wide voltage input, 5V2A fast charging

Network	Bluetooth: Supports BT 5.1 low power
NFC	13.56MHz, supports ISO14443A/B
Buttons	4 side buttons (Reset, Power, Function Up/Down)
External Interfaces	<ul style="list-style-type: none"> - Heating wire contact points - Pod detection contacts - Encryption chip communication contacts
Vaping Timeout	7 seconds auto-stop
Output Power (0.8Ω)	12.8~16W (stops output below 3.2V battery)
Charging Temperature Protection	150°C

2. Software Specifications

Item	Description
System Version	MCU System
Power Off	Long press Power button for 5s
Sleep/Wake	Power button
Restart	Reset button

3. Electrical Performance

Parameter	Item	Minimum	Typical	Maximum
Input Power	Voltage	2.8V	3.7V	4.2V
	Ripple	14mV	20mV	12mV
	Current	28mA	54mA	44mA
Environment	Relative Humidity	5%	--	90%
	Operating Temperature	0°C	--	50°C
	Storage Temperature	-10°C	--	70°C
Power Consumption	Screen ON + BT + NFC	--	71mA	--
	Screen OFF + BT + NFC	--	28mA	--
	Screen ON + BT	--	44.8mA	--
	Screen OFF + BT	--	608μA	--
	Screen ON + NFC ON	--	71mA	--

Power Consumption	Screen ON + NFC OFF	--	43.7mA	--
	Screen OFF + NFC ON	--	28.05 mA	--
	Screen OFF + NFC OFF	--	292μA	--



LICENSE NO.5144190085

Designed by Puffpaw in California

